

> **G139 DEVELOPER**

G139 is Agfa's excellent three-part high-quality developer.

G139 developer gives the best results in combination with G334(i) fixer.

> **G139 for automatic processing**

G139 developer is a high-quality developer for high-end automatic processors. It is used for conventional blue and green radiography and for laser imaging films. G139 is Agfa's developer which performs well in all large 90 seconds to 2 minutes processors at temperatures ranging from 32 °C to 35 °C. The best results are obtained when combining G139 developer with G334(i) fixer.

G139S starter for a perfect start

We recommend the use of G139S starting solutions whenever you replace the developer in conventional applications. You will thus obtain X-ray images with optimal sensitometric properties for conventional blue and green radiography films and for laser imaging films.

Ecologically improved packaging

The G139 developer is supplied in shipping cartons made of 60 % recycled cardboard. The cartons have been provided with two handles for easy tilting and transportation.

Parts A, B and C are packed in translucent polyethylene (PE) bottles fitted with PE ECO seals. The screw cap and the stripe at the top of the label are color-coded for identification purposes (red, transparent). The colored components, however, have been reduced as much as possible and the bottles show no aluminium remnants after use. Both features make the bottles easily PE-recyclable.

Designed for high-end automatic processors

Best results when combined with G334(i) fixer

Ecological packaging: no separate dismissal of empty bottles

Screw caps with built-in cutting edges for easy opening

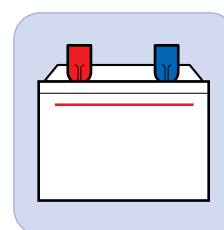
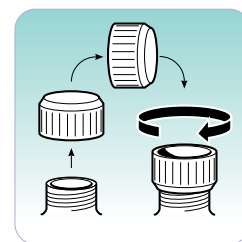

Bottles fit for automatic mixing units

Easy bottle handling

You can easily open the bottles using the built-in cutting edges of the cap.

Simply open the cap, place it upside down on the bottle, apply a little pressure and turn the cap clockwise to break the ECO seal.

Easy automatic mixing

You can easily mix the parts using the automatic mixing units. Remove the cap, invert the bottle with the ECO seal over the seal opener and press. The seal is automatically broken and the contents can flow into the tank on the mixing unit.

Whatever the mixing procedure, automatic or manual, mixing will never result in sludge formation.

Technical specifications

General rules

Temperature adjustment of the developer by 1 °C equals speed adjustment by 2 to 3 log E points.

Suited for

All kinds of processors, except tabletop processors
Not suited for manual processing.

Processing cycles

All processing cycles from 90 s to 180 s

Replenishment rate

Ranging from 300 to 600 ml/m²

Recommended fixer

G334 and G334i

Packaging:

One shipping carton G139 contains concentrate for 2x20 L of developer

Conditions

Make sure the processing room is well ventilated: air ventilation of 10 times the room volume per hour will prevent build-up of chemicals in the air.

Safety

Consult the Safety Data Sheet (SDS) for information relating to safety, health and environmental aspects.
Please follow the safety instructions mentioned on the bottles carefully.

The data in this publication are for illustration purposes only and do not necessarily represent standards or specifications which must be met by Agfa. Characteristics of the products described in this publication can be changed at any time without notice.

Agfa, the Agfa rhombus, Point of Knowledge and CURIX are trademarks of Agfa-Gevaert N.V., Belgium, or its affiliates.

Printed in Belgium
Published by Agfa-Gevaert N.V.
B-2640 Mortsel - Belgium
NDKSX GB 00200305 V01